

BRAZED PLATE HEAT EXCHANGER SELECTION



2899 Portland Drive
Oakville, ON L6H 5S4
Tel (905) 829 4666
Fax: (905) 829 4646



Domestic water

Hot side	Boiler water	180°F ⇄ 160°F
Cold side	Domestic water	40°F ⇄ 140°F

Pressure Drop of 20ft of Water or less

LC110Y models have significantly lower pressure drops than LC110X models

GPM		Model				BTU/h
Hot side	Cold side	LA14	LB31	LC110-X	LC110-Y	
2.6	0.5	LA14-10	LB31 - 10	LC110 - 10X	LC110 - 10Y	25,000
4.1	0.8	LA14-10	LB31 - 10	LC110 - 10X	LC110 - 10Y	40,000
5.2	1.0	LA14-10	LB31 - 10	LC110 - 20X	LC110 - 10Y	50,000
6.2	1.2	LA14-10	LB31 - 10	LC110 - 20X	LC110 - 10Y	60,000
7.7	1.5	LA14-20	LB31 - 10	LC110 - 20X	LC110 - 10Y	75,000
9.3	1.8	LA14-20	LB31 - 20	LC110 - 20X	LC110 - 10Y	90,000
10.0	2.0	LA14-20	LB31 - 20	LC110 - 20X	LC110 - 10Y	100,000
12.9	2.5	LA14-20	LB31 - 20	LC110 - 20X	LC110 - 20Y	125,000
14.4	2.8	LA14-30	LB31 - 20	LC110 - 20X	LC110 - 20Y	140,000
15.5	3.0	LA14-30	LB31 - 20	LC110 - 20X	LC110 - 20Y	150,000
18.0	3.5	LA14-30	LB31 - 30	LC110 - 20X	LC110 - 20Y	175,000
20.6	4.0	LA14-40	LB31 - 30	LC110 - 20X	LC110 - 20Y	200,000
25.7	5.0	LA14-50	LB31 - 40	LC110 - 30X	LC110 - 20Y	250,000
30.9	6.0	LA14-60	LB31 - 40	LC110 - 30X	LC110 - 30Y	300,000
36.1	7.0	-	LB31 - 60	LC110 - 40X	LC110 - 30Y	350,000
41.2	8.0	-	LB31 - 70	LC110 - 40X	LC110 - 40Y	400,000
46.4	9.0	-	LB31 - 80	LC110 - 50X	LC110 - 40Y	450,000
51.5	10.0	-	LB31 - 90	LC110 - 50X	LC110 - 40Y	500,000
56.7	11.0	-	LB31 - 90	LC110 - 50X	LC110 - 50Y	550,000
61.8	12.0	-	LB31 - 100	LC110 - 60X	LC110 - 50Y	600,000
67.6	13.0	-	LB31 - 110	LC110 - 60X	LC110 - 60Y	650,000
72.0	14.0	-	LB31 - 120	LC110 - 70X	LC110 - 60Y	700,000
77.2	15.0	-	-	LC110 - 70X	LC110 - 70Y	750,000
82.4	16.0	-	-	LC110 - 80X	LC110 - 70Y	800,000
92.7	18.0	-	-	LC110 - 90X	LC110 - 80Y	900,000
103.0	20.0	-	-	LC110 - 100X	LC110 - 90Y	1,000,000
Connections FNPT		3/4"	1"	1 1/2"	2 1/2"	
Plate dimensions		3" x 7.5"	5" x 12"	10" x 20"		

Default Nozzle Placement

- K1 – Hot Side INLET
- K2 – Cold Side OUTLET
- K3 – Cold Side INLET
- K4 – Hot Side OUTLET

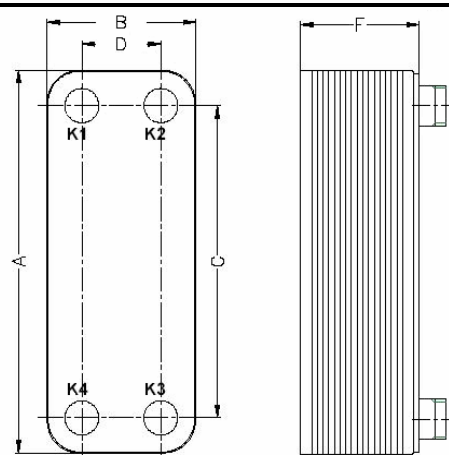

Heat Exchanger Type	Dimensions (in)					Plate Area (sq.ft.)
	A	B	C	D	F	
LA14	7.6	3.1	6.1	1.6	0.39+0.009NP	0.13
LB31	12.0	5.0	9.8	2.8	0.49+0.09NP	0.34
LC110X	20.9	9.8	17.9	6.9	0.51+0.09NP	1.22
LC110Y	20.6	9.5	16.9	5.8	0.53+0.11NP	1.12

NP = number of plates

Standard Construction:

Plates & Connections: AISI 316

Brazing Material: Copper (Optional-Nickel)
Single Wall Plates (Optional-Double Wall)

Design Parameters:

Working Pressure up to 481 PSI

Working Temperature up to 445° F

All charts are to be used for reference only. For any sizing information contact your AIC Sales Rep at 905-829-4666