

SUBMITTAL SHEET

JOB NAME	ITEM TAG
JOB LOCATION	PART NUMBER
CONTRACTOR	DATE
ENGINEER APPROVAL	DATE

PEX END BALL VALVE

T-2006

- Durable forged brass body
- Blowout-proof stem design
- Maintenance-free dual O-ring stem seal
- Compact body design is ideal for confined installations
- Chrome-plated ball resists mineral build-up
- Lever handle features a data tag mounting hole

- PEX barb ends comply with ASTM F1807
- Manufactured in an ISO 9002 accredited facility



Working Pressure, Non-Shock (PSI)

Saturated Steam: Not recommended for steam service

Cold Water, Oil, Gas: 400 CWP

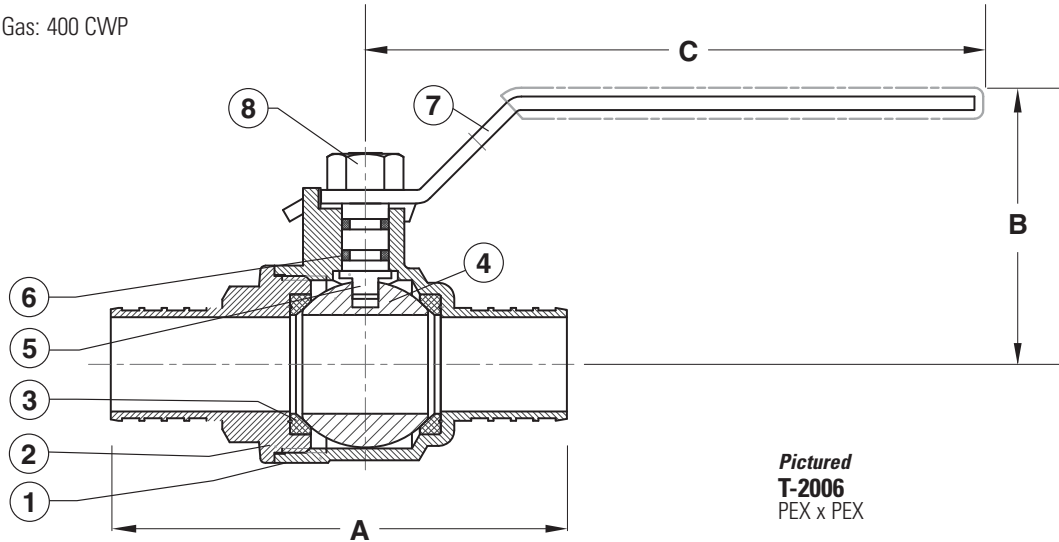

Pictured
T-2006
PEX x PEX

MATERIAL SPECIFICATION

PART	MATERIAL	SPECIFICATION
1 Body	Forged brass	ASTM B124 UNS C37700
2 End Adapter	Forged brass	ASTM B124 UNS C37700
3 Seats (2)	PTFE	Dupont Teflon
4 Ball	Chrome plated forged brass	ASTM B124 UNS C37700
5 Stem	Forged brass	ASTM B124 UNS C37700
6 Stem O-rings (2)	NBR (Buna-N) rubber	Commercial grade
7 Handle	Steel	ASTM A570 Gr. A
8 Handle Nut (5/16-18 UNC)	Steel	ASTM A570 Gr. A

DIMENSIONS

Size	A	B	C
1/2"	2.32	1.34	3.27
3/4"	2.52	1.44	3.27