

ZONE CONTROL ZCP

- Controls up to Five Zone Pumps or Zone Valves with Optional DHW Priority
- Secondary Priority Heating Zone for Hard to heat Zones
- Built-in Digital Display with English Menus

Description:



A Five-Zone Control that can operate either Zone Pumps or Zone Valves. One Zone Control to Stock. The same control can be configured to operate either Zone Pumps or Zone Valves with End Switches. Just select the proper output.

- **Domestic Hot Water Zone.** The first Zone can be configured either as a heating zone or a Domestic Hot Water (DHW) zone. The DHW Zone can then be configured to either have priority or to run without priority. When Priority is selected, An adjustable Priority Time Delay is provided for better control.

- **Secondary Hard to Heat Priority Zone.** Even with DHW Priority set, the ZCP can configure a zone to be excluded from the priority. This can be helpful for hard to heat zones. The ZCP will provide heat to those zones even during DHW priority calls.
- **Digital Display of All Zones Status.** The ZCP is equipped with a two line digital display. It displays all menu items in simple English. In addition, all zone status will be displayed.
- **Expandable to 10 Zones.** Although a single ZCP can control five zones, two ZCPs can be daisy chained to offer a total of up to ten zones. One will act as the master while the other will be the Slave/Extension. Phone Cable used to connect the two ZCPs must be ordered separately.
- **Interface with the HWE-SS Outdoor Reset Control.** The ZCP can be wired to control the boiler and the system pump. Additionally, it can be wired to an outdoor reset control as the HWE-SS to take advantage of its Outdoor Reset and DHW Set Point capabilities.
- **Ease of Wiring.** The ZCP eases the wiring by allowing the power source for the Zone outputs to connect directly to the Source terminals. That means less wiring and simpler installation and troubleshooting.
- **Boiler Warm Up Period.** To help reduce the effect of circulating cold water to the zones when the boiler has not run for an hour, a call for any of the zones will energize the Boiler and System Pump relays. However, all zone outputs will be energized after the boiler warm up period.
- **Pump Delay.** An adjustable Run-On delay is provided to help dissipate the excess heat from the system in to the zones.
- **Pump Exercise.** With this option activated, the rate of pump failure will be improved drastically as they will run for a few seconds for every week of inactivity.

ISO 9001:2000
CERTIFIED

Item Description

ZCP (Controls 5 Zones with Optional Domestic Hot Water)

Extension/Slave Cable

Part

926577-00

018017-00

ZCP PANEL

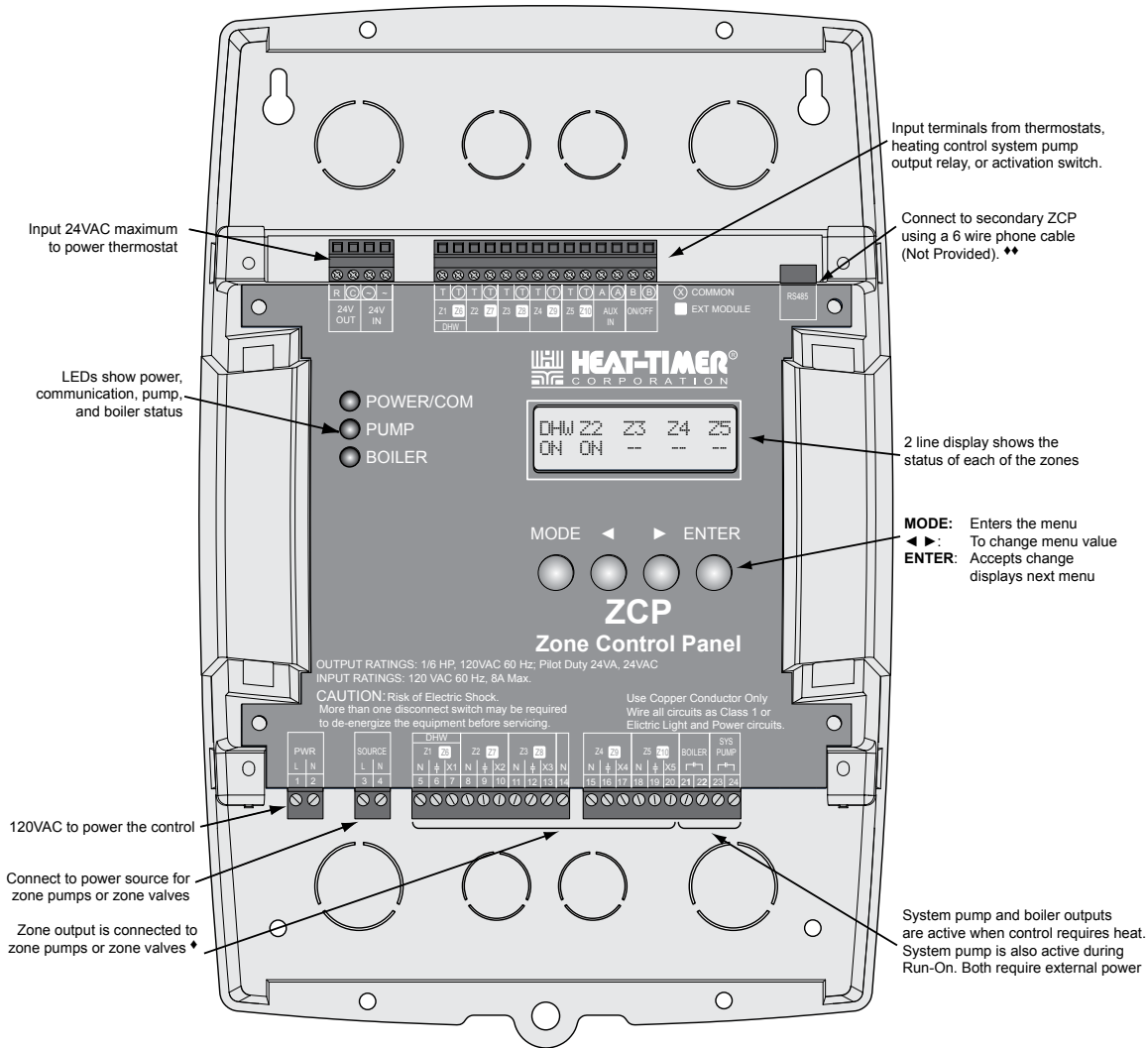

- ♦ Only one type of output can be connected to the ZCP. Either Zone Valves or Zone Pumps. Mixing output types will cause control damage.
- ♦♦ To connect two ZCP controls, one control must be set as a Master [y] while the other Master [n].

Specifications:

Voltage Input:	120 VAC 60 Hz
Power Consumption:	15 VA Max
System Pump and Boiler Outputs:	2 N.O. S.P.S.T
Zone Outputs:	5 N.O. S.P.S.T with zones valve end-switch input
Zone Pump Output Relay Ratings:	1/6 HP, 120 VAC 60 Hz
Zone Valve Output Relay Ratings:	1 Amp at 24VAC 60 Hz
Display:	32 character (2 rows with 16 characters each)
LEDs:	3 (1 Power/Communication, 1 System Pump, and 1 Boiler)
Buttons:	4 (Mode, ◀, ▶, and Enter)
Control Operating Mode:	Master or Slave
Zone Operation Modes:	Zone Valve or Zone Pump
Boiler warm-up:	0, 2, 5, 10 minutes
Pump Run-On:	0, 2, 5, 10 minutes
Domestic Hot Water:	Zone 1 is adjustable as heating zone or DHW zone
Domestic Hot Water Priority:	Can be set to No Priority, 30, or 60 minute priority
Pump Exercise:	Can be enabled or disabled
Thermostat Inputs:	5 Thermostat inputs (can be dry contact or 24 VAC)
Enable/Disable Input:	1 Dry-contact adjustable to enable on Short or Open
Dimensions:	.3-1/2" x 13-1/4" x 8-3/4"
Weight:	2 pounds